

## 69, 85 Series Analogue Panel Meter



### 1 Overview

85 and 69 series meters consist of a measuring line, a measuring mechanism and an indicator device. The magneto-electricity system magnetic structure is used. With plastic housing, full-transparent organic glass window, and printed scale panel used, the entire structure is elegant and artistic with wide open view.

### 2 Technical parameters

Product name	Spec.	Measurement range	Accuracy grade
DC ammeter	85C1-A 69C9-A 85C17-A 69C17-A	50 $\mu$ A-20A (direct connection) 20A-10kA/75mV/60mV (external device)	Grade 2.5
DC voltmeter	85C1-V 69C9-V 85C17-V 69C17-V	50V-600V (direct connection) 450V-450kV/1mA/5mA (external device)	Grade 2.5
AC ammeter	69L9-A 69L17-A 85L1-A 85L17-A	500mA-30A (direct connection) 5A-10kA/5A/1A (external device)	Grade 2.5
AC voltmeter	69L9-V 69L17-V 85L1-V 85L17-V	15V-600V (direct connection) 380V-450kV/100V (external device)	Grade 2.5
Frequency meter	85L1-H 69L9-H	45-55Hz, 45-65Hz, 55-65Hz Equivalent rated voltage 100V 200V 380V	Grade 2.5

### 3 Outline and installation dimension

85L1, 85C1 series meter

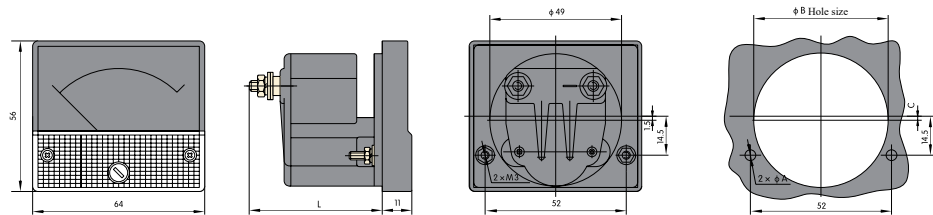

Product model	Spec.	L	A	B	C
85L1-A/V	Current $\geq 25A$	51.5	3.5	53.5	0
	Current $< 25A$ , available for all voltages	49.5	4	50	1.5

## 69, 85 Series Analogue Panel Meter

69L9, 69C9 series meter

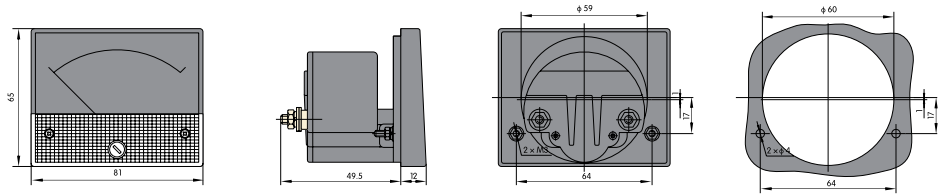

85L17, 85C17 series meter

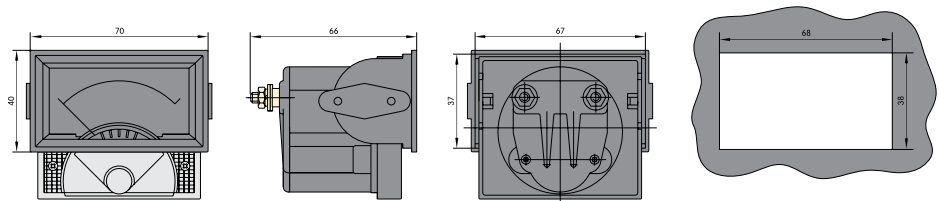

69L17, 69C17 series meter

